

FIVC Ball Valve

DZR Brass – PN 25/40 – Full Port – Extended T-handle – ISO 228

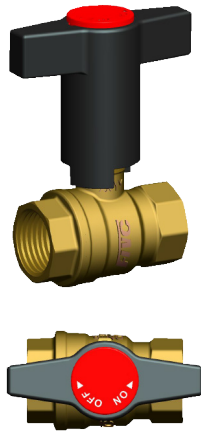

FBA series

Technical data

Main features and materials

- Body: DZR Brass
- Stem: Brass
- Ball: Stainless Steel
- T-Lever: POM
- Standard: EN 13828
- Seat: PTFE
- USP: Extended T-handle
Dezincification resistant
Long service life

Field of applications

- Temperature range: -10 to 120 °C
- Max. working pressure: 40/25 bar

- Water
- Chilled Water
- HVAC

Description

FIVC Ball Valve provides full port, hence implies less resistance in the flow. The valve is designed with extended stem and Female-Female connections and is suitable for several applications including heating, glycol, and industry. The valve is constructed in DZR Brass. The valve can be used for water.

Declaration

The product has been inspected and tested in accordance with the Sound Engineering Practice SEP. Acc. to the European PED Directive N° 2014/68/EU, dated 15/05/2014, the product is exempted from CE marking (Cf. Art. 4.3).

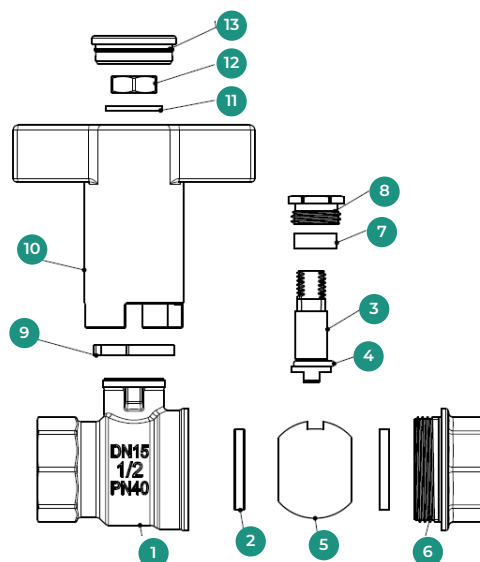
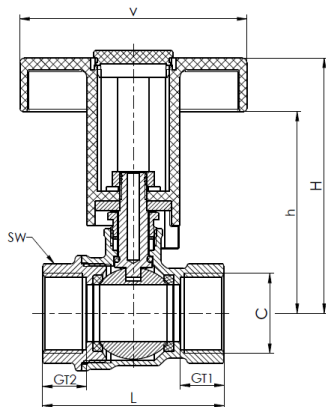

Product code	Size	PN	d	L	GT1	GT2	v	h	H	SW
FBA010D40XT33	10	40	10	42.0	11.0	11.0	59.5	51.0	65.0	20.0
FBA015D40XT33	15	40	15	47.5	11.5	11.5	59.5	53.0	67.0	24.5
FBA020D40XT33	20	40	19	54.5	12.5	12.5	59.5	57.0	71.0	30.0
FBA025D40XT33	25	40	24	61.0	13.5	13.5	79.0	61.0	76.0	37.0
FBA032D25XT33	32	25	30	71.5	15.0	14.5	79.5	68.0	82.0	46.5
FBA040D25XT33	40	25	37	85.0	18.0	16.3	109	94.5	112.5	52.5
FBA050D25XT33	50	25	47	101	21.0	17.0	109	103	121.0	65.0

Dimensions are in millimeters

Product Specification

N°	Name	Material
1	Body	DZR Brass C2 132
2	Seats	PTFE
3	Stem	Brass
4	O-ring	EPDM
5	Ball	Stainless Steel AISI 304
6	Body cap	DZR Brass C2 132
7	Gland Packing	PTFE
8	Gland	Brass
9	Torque plate	Steel
10	T-lever	POM
11	Washer	Steel
12	Flat nut	Steel
13	Cap	POM